

Rhif: 9

 Rhif y Cais / Application Number : C14/1065/42/LL
Cynllun lleoliad ar gyfer adnabod y safle yn unig. Dim i raddfa.
Location Plan for identification purposes only. Not to scale.

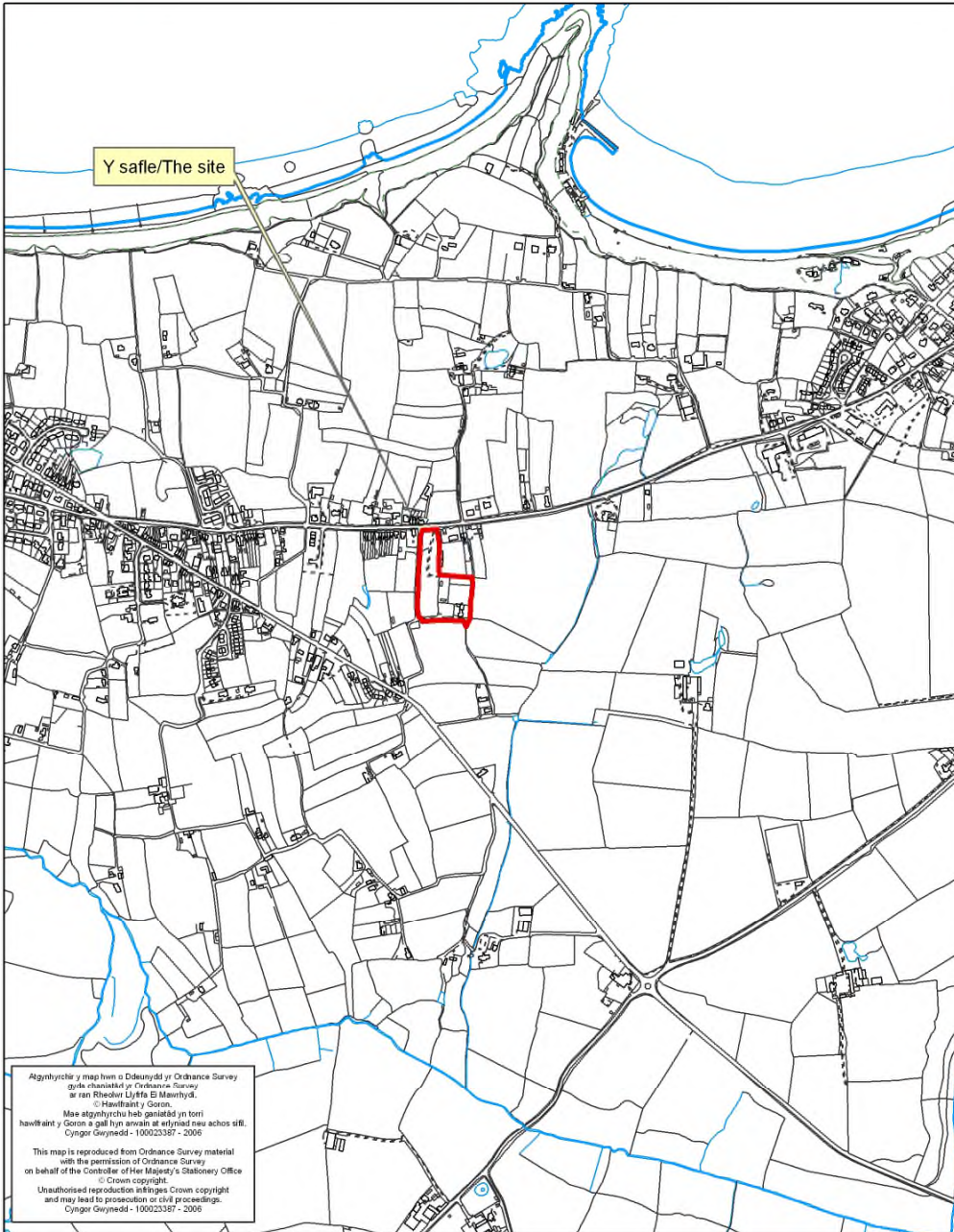

PWYLLGOR CYNLLUNIO	DYDDIAD: 12/01/2015
ADRODDIAD UWCH REOLWR GWASANAETH CYNLLUNIO AC AMGYLCHEDD	CAERNARFON

Cais Rhif: C14/1065/42/LL
Dyddiad Cofrestru: 20/10/2014
Math y Cais: Llawn - Cynllunio
Cymuned: Nefyn
Ward: Morfa Nefyn

Bwriad: LLEOLI 7 LLAIN CARAFAN TEITHIOL NEWYDD AR Y SAFLE PRESENNOL YNGHYD AG YMESTYN Y SAFLE I LEOLI 14 LLAIN CARAFAN TEITHIOL GYDA GWELLIANNAU I'R FYNEDFA I'R SAFLE, TIRLUNIO A GWAITH CYSYLLTIOL
Lleoliad: TY'N Y COED TOURING PARK, MORFA NEFYN, PWLLHELI, GWYNEDD, LL536BP

Crynodeb o'r Argymhelliad: CANIATÁU GYDAG AMODAU

1. Disgrifiad:

- 1.1 Cais yw hwn ar gyfer cynyddu niferoedd ac ymestyn safle carafanau teithiol 20 carafán bresennol yn Tŷ'n y Coed, Morfa Nefyn. Byddai'r bwriad arfaethedig yn golygu ychwanegu 7 llain newydd o fewn y safle presennol gan gynnwys gwelliannau i'r fynedfa, tirlunio a gwaith cysylltiol. Bwriedir hefyd i ymestyn y safle i gae cyfochrog, ble saif y cyfleusterau toiledau presennol a charafán sefydlog hanesyddol, er mwyn lleoli 14 carafán deithiol o amgylch ffiniau'r cae. Byddai'r nifer ychwanegol arfaethedig o 21 carafan felly, yn rhoddi cyfanswm o 41 uned ar y safle.
- 1.2 Saif y safle ym mhentref Morfa Nefyn a cheir mynediad oddi ar y brif ffordd sirol y B4417 i mewn i'r safle. Deallir bod y safle'n gweithredu fel maes carafanau teithiol ers y 1990au cynnar. Mae ffiniau'r safle wedi eu tirlunio gyda gwrychoedd aeddfed a choed yma thraw o fewn y safle. Ceir llwybr cyhoeddus tu hwnt i wrych terfyn ffin ddwyreiniol y safle estynedig a ffordd sirol gul ddi-ddosbarth tu draw i ffin orllewinol y safle. Mae'r safle tu allan i ffin datblygu pentref Morfa Nefyn ac mae o fewn tir, sydd wedi ei ddiffinio ym mapiau gosodiad Cynllun Datblygu Unedol Gwynedd, fel llecyn agored i'w warchod rhwng pentref Morfa Nefyn a chanolfan leol Nefyn.
- 1.3 Cyflwynir y cais i'r Pwyllgor gan ei fod yn ymwneud a datblygiad o 5 carafán neu fwy.

2. Polisiâu Perthnasol:

- 2.1 Mae Adran 38(6) o Ddeddf Cynllunio a Phrynu Gorfodol 2004 a pharagraff 2.1.2 Polisi Cynllunio Cymru yn pwysleisio y dylid penderfynu ceisiadau yn unol â'r Cynllun Datblygu, oni bai bod ystyriaeth faterol cynllunio yn nodi fel arall. Mae ystyriaethau cynllunio yn cynnwys Polisi Cynllunio Cenedlaethol, a'r Cynllun Datblygu Unedol.

2.2 Cynllun Datblygu Unedol Gwynedd 2009:

POLISI A2 GWARDHOD GWEAD CYMDEITHASOL, IEITHYDDOL A DIWYLLIANNOL CYMUNEDAU Diogelu cydlynid cymdeithasol, ieithyddol neu ddiwylliannol cymunedau rhag niwed arwyddocaol oherwydd maint, graddfa, neu leoliad cynigion.

POLISI B11 LLECYNNAU AGORED RHWNG NEU O FEWN PENTREFI A THREFI Sicrhau y gwrthodir cynigion fyddai'n achosi niwed arwyddocaol i swyddogaeth neu bwysigrwydd llecynnau agored rhwng trefi/pentrefi neu lecynnau o fewn trefi neu bentrefi sy'n bwysig i'w gymeriad.

PWYLLGOR CYNLLUNIO	DYDDIAD: 12/01/2015
ADRODDIAD UWCH REOLWR GWASANAETH CYNLLUNIO AC AMGYLCHEDD	CAERNARFON

POLISI B23 MWYNDERAU Diogelu mwynderau'r gymdogaeth leol drwy sicrhau bod rhaid i gynigion gydymffurfio â chyfres o feini prawf sy'n anelu i warchod nodweddion cydnabyddedig a mwynderau'r ardal leol.

POLISI B27 CYNLLUNIAU TIRLUNIO Sicrhau fod cynigion a ganiateir yn ymgorffori tirlunio meddal/caled o safon uchel sy'n briodol ar gyfer y safle ac sy'n ystyried cyfres o ffactorau sy'n anelu i osgoi niwed i nodweddion cydnabyddedig.

POLISI CH22 Gwarchodir pob rhan o'r rhwydwaith beicio, llwybrau a hawliau tramwy trwy annog cynigion fydd yn eu hymgorffori yn foddhaol o fewn y datblygiad a thrwy wahardd cynlluniau i ymestyn y rhwydwaith beicio, llwybrau a hawliau tramwy. Os na fydd hyn yn bosib bydd yn rhaid gwneud darpariaeth briodol i wyro'r llwybr neu i ddarparu llwybr newydd boddhaol.

POLISI CH33 DIOGELWCH AR FFYRDD A STRYDOEDD Caniateir cynigion datblygu os gellir cydymffurfio gyda meini prawf penodol sydd yn ymwneud a'r fynedfa gerbydau, safon y rhwydwaith ffyrdd presennol a mesurau tawelu traffig.

POLISI D20 SAFLEOEDD CARAFANAU TEITHIOL, GWERSYLLA AC UNEDAU TEITHIOL – ESTYNIADAU, LLEINIAU YCHWANEGOL, ADLEOLI A CHYFNEWID Caniatáu cynigion i gynyddu nifer y lleiniau, estyniadau i safleoedd, neu adleoli lleiniau neu gyfnewid llecynnau os yw'r cynnig yn ffurfio rhan o gynllun i sicrhau gwelliannau amgylcheddol a gweledol, a meini prawf eraill sy'n ymwneud ag effaith y datblygiad ar yr ardal leol.

Canllaw Cynllunio Atodol, Cyngor Gwynedd: Llety Gwyliau (Gorffennaf 2011)

Canllaw Cynllunio Atodol, Cyngor Gwynedd: Cynllunio a'r Iaith Gymraeg (Tachwedd 2009)

2.3 Polisiau Cenedlaethol:

Polisi Cynllunio Cymru 2014

Nodyn Cyngor Technegol 13 – Twristiaeth

Nodyn Cyngor Technegol 18 – Trafnidiaeth

Nodyn Cyngor Technegol 20 – Cynllunio a'r Iaith Gymraeg

3. Hanes Cynllunio Perthnasol:

C00D/0163/42/LL Adeiladu bloc toiledau a chawodydd: Caniatáu 23 Mehefin 2000

C98D/0453/22/LL Lleoli 10 carafán ychwanegol: Caniatáu 3 Mehefin 1999

C98D/0218/22/LL Defnyddio tir ar gyfer storio carafanau teithiol yn ystod y tymor gwyliau: Gwrthod 31 Gorffennaf 1998

2/22/310C Safle i 10 carafán deithiol: Caniatáu 21 Gorffennaf 1994

2/22/310B Cyfleusterau toiledau: Caniatáu 22 Ionawr 1992

2/22/310A Safle i 10 carafán deithiol (ni weithredwyd): Caniatáu 31 Hydref 1986

2/22/310 Mynedfa ar gyfer carafanau teithiol Caniatáu 1 Mawrth 1983

3/4/816 Lleoli un garafán (sefydlog) Caniatáu 30 Gorffennaf 1965

PWYLLGOR CYNLLUNIO	DYDDIAD: 12/01/2015
ADRODDIAD UWCH REOLWR GWASANAETH CYNLLUNIO AC AMGYLCHEDD	CAERNARFON

4. Ymgynghoriadau:

- Cyngor Cymuned/Tref: Dim gwrthwynebiad.
- Uned Drafnidiaeth: Cyfeiriaf at y cais uchod a chadarnhaf nad oes gennyf wrthwynebiad i'r bwriad. Mae'r safle yn ochri ag un o'r prif ffyrdd, sef y ffordd ddosbarth B trwy bentrefi Nefyn a Morfa Nefyn, ac felly tydi'r cynnydd mewn niferoedd ddim yn debygol o gael effaith andwyol ar y rhwydwaith ffyrdd. Nodaf hefyd y bwriad i newid y ffiniau gyda'r briffordd a chadarnhaf nad oes gennyf wrthwynebiad os cadwir at yr un llinell tirlunio.
- Uned Gwarchod y Cyhoedd: Cyflwyno sylwadau o agwedd cydymffurfiaeth a thrwydded safle.
- Uned Llwybrau: Mae'r Adran Cefn Gwlad a Mynediad yn bryderus i sicrhau bydd llwybr cyhoeddus rhif 11 B Nefyn yn cael ei warchod yn ystod ac ar ddiwedd y datblygiad.
- Dŵr Cymru: Heb eu derbyn
- Gwasanaeth Tan: Heb eu derbyn
- Ymgynghoriad Cyhoeddus: Rhoddwyd rhybudd ar y safle a hysbyswyd y cymdogion agosaf. Mae'r cyfnod hysbysebu wedi dod i ben ar 27 Tachwedd 2014. Ni dderbyniwyd unrhyw wrthwynebiad.

5. Asesiad o'r ystyriaethau cynllunio perthnasol:

Egwyddor y datblygiad

- 5.1 Mae polisi D20 o GDUG yn caniatáu cynigion i gynyddu nifer y lleiniau ar safleoedd carafanau teithiol presennol fel estyniad, cyhyd a bod y cynnig yn ffurfio rhan o gynllun a fydd yn arwain at welliannau amgylcheddol a gweledol o ran lleoliad, gosodiad, dyluniad a gwedd y safle a'i le yn y dirwedd o'i amgylch. Yn ogystal, mae gofyn na fydd y datblygiad arfaethedig tu hwnt i allu rhesymol y cyffiniau i gynnwys datblygiad o'r fath, wrth ystyried unrhyw effaith gronol safleoedd carafanau teithiol presennol.
- 5.2 Mae'r bwriad gerbron yn estyniad i safle sydd â hawl presennol i 20 carafán deithiol. Bwriedir ychwanegu 7 llain newydd i'r safle presennol, ymgymryd â gwelliannau i'r fynedfa, tirlunio ynghyd a gosod 14 carafán deithiol newydd a'r gae cyfochrog, fyddai'n rhoddi cyfanswm o 41 uned ar y safle. Mae'r cae presennol yn ymestyn yn hir a gwastad oddi wrth ffordd sirol y B4417 ac yn gymharol ddisylw yn y tirlun, gyda chlawdd wedi ei blannu ar y ffin gyda'r lon. Ceir gwrychoedd aeddfed ar weddill y ffiniau. Mae'r cae sy'n destun yr estyniad hefyd yn ddisylw, wedi ei leoli tu ôl i adeiladau amaethyddol eiddo Bryn Iddon ac eto wedi ei dirlunio'n dda o amgylch y ffiniau. Saif bloc cyfleusterau toiledau'r safle yn y cae yma, ynghyd a charafán sefydlog hanesyddol. Ymddengys bod gwelliannau amgylcheddol eisoes wedi eu gwneud yn ddiweddar o fewn y safle, gyda lôn llechi man, safle parcio a phlannu wedi cymryd lle. Bwriedir ymgymryd ag ychwaneg o dirlunio fel rhan o'r bwriad, fyddai'n cynnwys gosod rhes o goed ar ganol cae'r estyniad a phlannu coed o fewn

terfynau'r gwrychoedd presennol. Nid yw'r safle'n amlwg nac ymwithiol yn y tirlun nac yn cael ardrawiad niweidiol o ran mwynderau gweledol y cyffiniau. Credir bod lleoliad, gosodiad unedau a thirlunio o fewn y safle yn sicrhau y byddai'r unedau newydd yn integreiddio'n dderbyniol i'r safle. Tra sylweddolir fod y nifer o unedau teithiol yn dyblu ar y safle, credir bod y niferoedd o fewn gallu rhesymol y cyffiniau i ymdopi a'r cynnydd o ystyried bod y safle'n ganolog yn y pentref ac yn agos i'r rhwydwaith ffordd sirol a chludiant cyhoeddus. Mae'r gwelliannau amgylcheddol a gynigir hefyd yn dderbyniol i wella gwedd y safle, sydd eisoes o safon uchel a dymunol. Nid oes safle teithiol yng nghyffiniau agos y safle, nac yn yr un cyd-destyn gweledol felly ni ystyrir bod effaith gronol yn bodoli yn yr achos yma. Ystyrir felly fod y bwriad dan sylw yn cydymffurfio a gofynion polisi B27 tirlunio a D20 CDUG sy'n ymwneud ac ymestyn a lleiniau ychwanegol ar safleoedd carafanau teithiol presennol.

- 5.3 Nodir bod safle'r cais o fewn tir sydd wedi ei ddynodi ym mapiau cynigion CDUG fel llecyn agored i'w warchod rhwng pentrefi Morfa Nefyn a Nefyn. Gan mai safle carafanau teithiol presennol yw hwn, gyda'r estyniad ymysg a thu ôl i adeiladau presennol ni ystyrir fod yr hyn sy'n cael ei gynnig yn cyfaddawdu nac yn ymwithio'n sylweddol arwyddocaol i'r llecyn agored i'w warchod. Ystyrir fod y bwriad yn dderbyniol yn nhermau polisi B11 CDUG.

5.4 **Mwynderau trigolion cyfagos**

Mae'r safle carafanau wedi ei leoli yng nghanol pentref Morfa Nefyn ac felly yn sgil hynny mae tai annedd i'w cael gerllaw i'r safle. Ystyrir fod digon o le ar gyfer y cynnydd mewn nifer heb ôr ddatblygu'r safle ac er y byddai peth gynnydd yn y traffig fyddai'n defnyddio'r safle, ni ystyrir y byddai'r cynnydd yma yn achosi niwed arwyddocaol i amwynderau lleol o gofio safon y ffordd. Mae'r safle wedi ei sgrinio'n dda ac felly ei ardrawiad wedi ei gynnal o fewn y ffiniau. O gymryd y defnydd presennol i ystyriaeth, ni ystyrir y byddai'r bwriad yn achosi niwed arwyddocaol i fwynderau'r gymdogaeth leol. Ni dderbyniwyd unrhyw wrthwynebiad gan gymdogion i'r bwriad. Credir fod y bwriad yn dderbyniol o safbwynt Polisi B23 Mwynderau CDUG.

5.5 **Materion trafndiaeth a mynediad**

Ceir mynedfa i'r safle oddi ar ffordd sirol dosbarth 2 y B4417 sy'n syth a gwastad ac mae'r agoriad fymryn tu allan i barth cyflymder 30 milltir yr awr. Ceir gweledd boddhaol i'r naill gyfeiriad ac ystyrir yn dderbyniol o ran diogelwch ffyrdd. Ni ystyrir fod y cynnydd mewn niferoedd yn debygol o gael effaith andwyol ar y rhwydwaith ffyrdd o ystyried safon y ffordd. Ceir lle parcio digonol o fewn y safle a man parcio gorlif sydd wedi ei wella yn ddiweddar. Ymddengys bod gwaith diweddar wedi ei wneud i'r fynedfa hefyd a bwriedir gwella'r plannu ar y clawdd. Nid oes gan yr Uned Drafndiaeth unrhyw wrthwynebiad i'r bwriad ac felly ystyrir yn cydymffurfio a gofynion polisi CH33 sy'n ymwneud a diogelwch ffyrdd.

- 5.6 Gan fod y llwybr cyhoeddus ochr draw i wrych terfyn dwyreiniol y cae sy'n destun yr estyniad, ni fydd y bwriad yn amharu ar gwrs y llwybr nac yn rhwystro ei ddefnydd yn yr achos yma felly yn dderbyniol ar sail polisi CH22 CDUG.

5.7 **Materion Ieithyddol**

Mae Polisi A2 CDUG yn nodi y dylid gwrthod cynigion a fyddai, oherwydd eu maint, eu graddfa neu eu lleoliad yn achosi niwed arwyddocaol i gydlyniad cymdeithasol, ieithyddol neu ddiwylliannol cymunedau. Gan fod y bwriad yn ymwneud gyda datblygiad twristiaeth a fydd yn creu deg neu fwy o unedau gwyliau

PWYLLGOR CYNLLUNIO	DYDDIAD: 12/01/2015
ADRODDIAD UWCH REOLWR GWASANAETH CYNLLUNIO AC AMGYLCHEDD	CAERNARFON

mae gofyn fod Datganiad Ieithyddol a Chymunedol yn cael ei baratoi er cydymffurfio gyda gofynion Canllaw Cynllunio Atodol: Cynllunio a'r Iaith Gymraeg. Derbyniwyd Datganiad Ieithyddol a Chymunedol fel rhan o'r cais ac ymgynghorwyd gyda'r Uned Polisi ar y Cyd. Derbyniwyd eu hymateb sy'n nodi na chredir fod natur na graddfa'r datblygiad yn debygol o gael effaith andwyol ar yr iaith Gymraeg. Gan fod y cynnig yn gyfan gwbl ar gyfer lleiniau teithiol, ac nid parhaol, mae'n annhebygol y byddai'r datblygiad yn cael ardrawiad ar fewnfudiad i'r ardal. Ar sail yr ymateb ystyrir fod y bwriad yn dderbyniol yng nghyd destun polisi A2 CDUG.

6. Casgliadau:

- 6.1 Nid yw'r safle dan sylw yn ymwithiol nac amlwg yn y dirwedd ac felly credir yn safle addas i dderbyn unedau ychwanegol. Mae'n safle o safon uchel ac wedi ei dirlunio'n dda ar hyd y ffiniau, a byddai'r tirlunio ychwanegol yn arwain at welliannau amgylcheddol fyddai'n cyfrannu'n gadarnhaol i osodiad a gwedd yn y dirwedd. Ni ystyrir y bydd niwed i fwynderau trigolion cyfagos yn sgil y cais, o gofio bod hwn yn safle presennol ac mae'r safle yn agos i'r rhwydwaith ffyrdd. Gan mai safle teithiol ydyw ni ystyrir y bydd effaith niweidiol i'r iaith Gymraeg yn sgil y datblygiad. Ystyrir bod y bwriad yn cydymffurfio gyda'r polisiâu a drafodwyd uchod ac felly yn dderbyniol i'w ganiatáu gydag amodau cynllunio perthnasol

7. Argymhelliad:

- 7.1 Caniatáu gydag amodau -

- 5 mlynedd
- Unol Â'r cynlluniau
- Cyfyngu niferoedd
- Cyfnod gweithredu
- Cyfnod amser / teithiol yn unig
- Gwyliau yn unig,
- Cadw cofrestr
- Tirlunio
- Diogelu llwybrau cyhoeddus
- Dim storio



Rhif y Cais / Application Number : C14/1065/42/LL

Cynllun lleoliad ar gyfer adnabod y safle yn unig. Dim i raddfa.
Location Plan for identification purposes only. Not to scale.



Atgynhyrchir y map hwn o Ddeunydd yr Ordnance Survey gyda chaniatâd yr Ordnance Survey ar ran Rheolwr Llyfrfa El Mawrhydi.
Hawlfraint y Goron.
Mae atgynhyrchu heb ganiatâd yn torri hawlfraint y Goron a gall hyn arwain at erlyniad neu achos eidd.
Cynkor Gwynedd - 100023387 - 2006

This map is reproduced from Ordnance Survey material with the permission of Ordnance Survey on behalf of the Controller of Her Majesty's Stationery Office
Crown copyright.
Unauthorised reproduction infringes Crown copyright and may lead to prosecution or civil proceedings.
Cynkor Gwynedd - 100023387 - 2006

20 HYD 2014

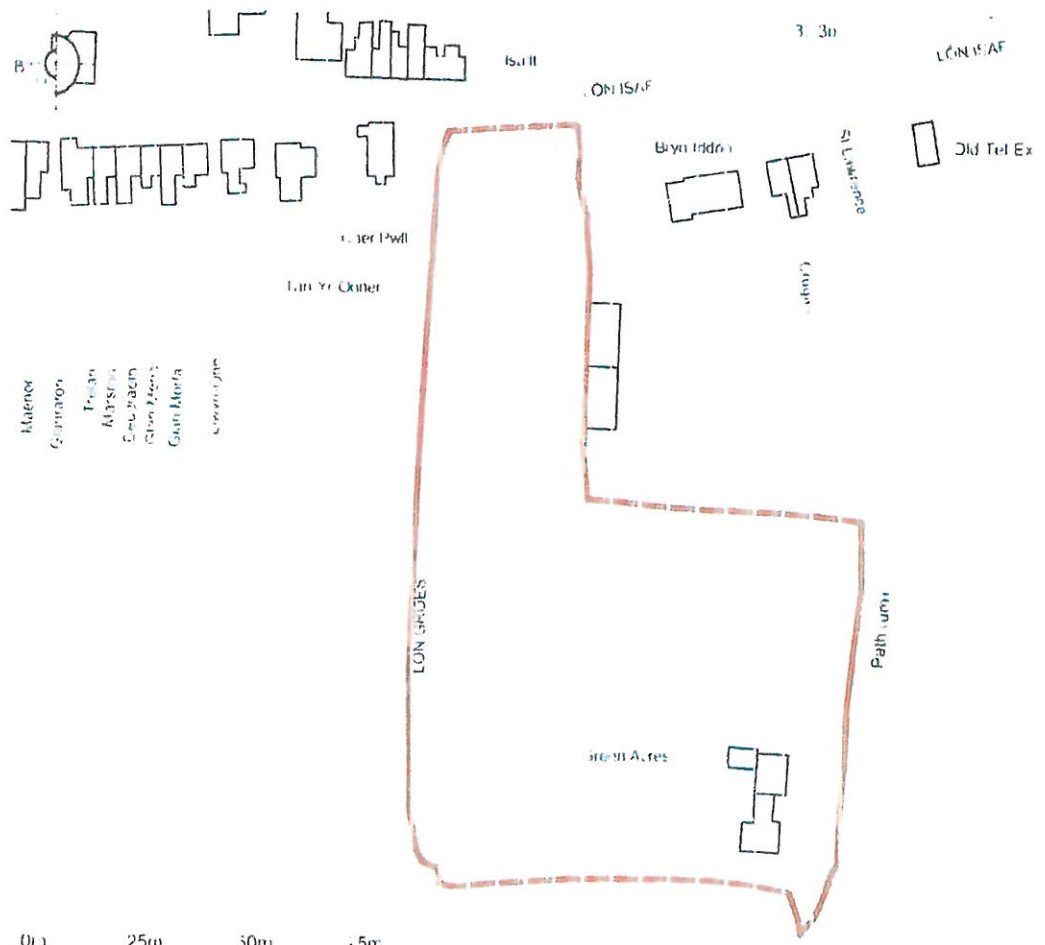

Greenacres Caravan Park
 Morfa Neŷyn,
 Pwllheli
 LL53 6EP

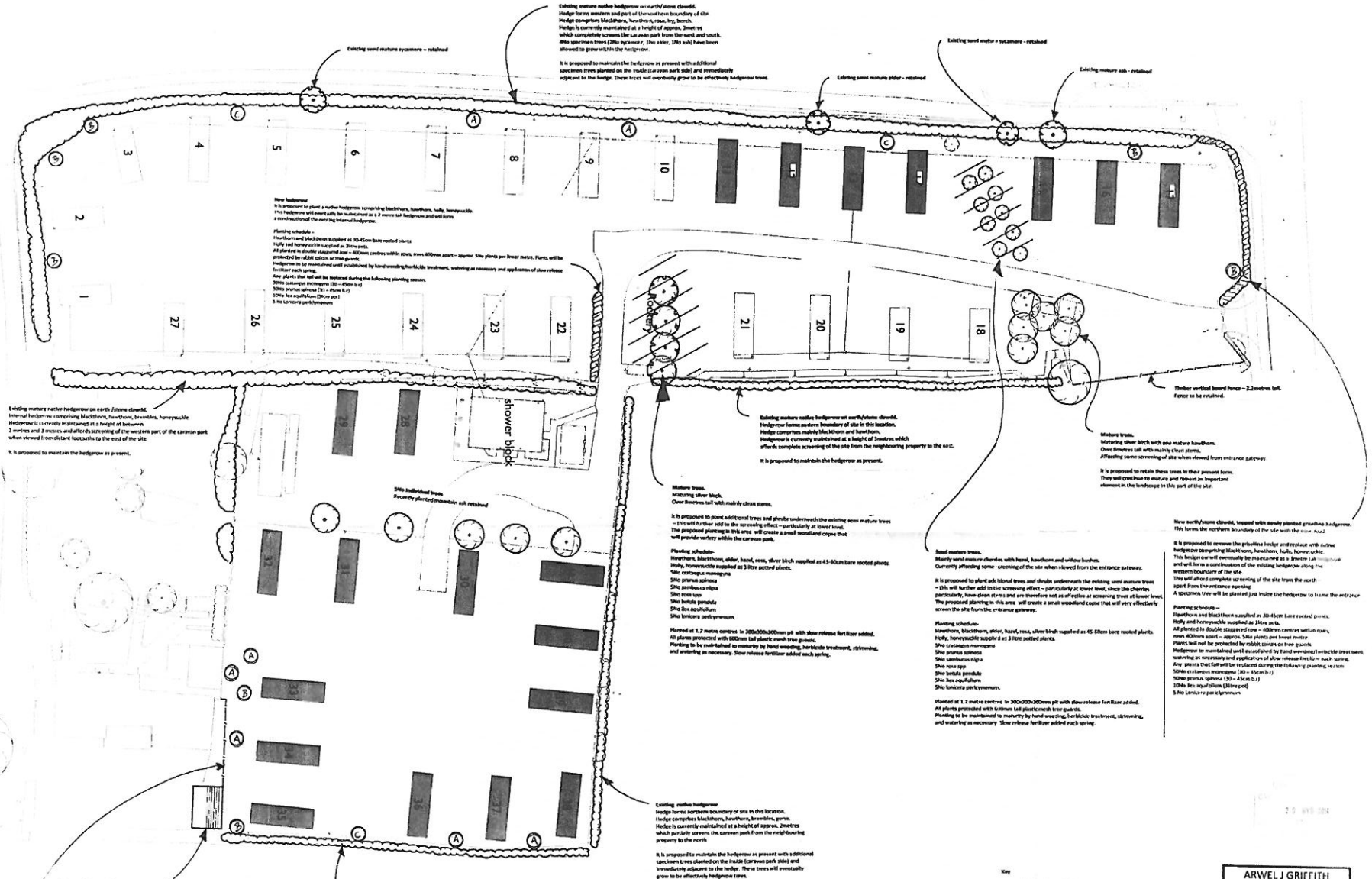

Existing mature hedge on north/south divide. Hedge forms western and part of the northern boundary of the site. Hedge comprises blackthorn, hawthorn, rose, ivy, brambles. Hedge is currently maintained at a height of approx. 2metres which completely screens the car park from the east and south. This species trees (20m or greater) - Silver Birch, Silver Birch are allowed to grow within the hedge line.

It is proposed to maintain the hedge as present with additional specimen trees planted on the inside (car park side) and immediately adjacent to the hedge. These trees will eventually grow to be effectively hedgehog trees.

Editing wind mature specimen - retained

It is proposed to plant a further hedgehog consisting blackthorn, hawthorn, ivy, hawthorn, ivy. The hedges will need to be maintained as a 2 metre tall hedge and will form a reproduction of the existing hedgehog.

Planting schedule - Hawthorn and blackthorn supplied as 30-45cm bare rooted plants. Holly and hawthorn supplied as 30cm pots. All plants to double staggered row - 400mm centres within rows, rows 800mm apart - square. The plants per linear metre. Plants will be protected by rigid cloche or tree guards. Hedges to be maintained until established by hand weeding/ herbicide treatment, watering as necessary and application of slow release fertilizer each year.

Any plants that fail will be replaced during the following planting season.

Site constraints: 20m (approx) (30m x 45m) 20m (approx) (30m x 45m) 3 No Lonicera periclymenum

Editing wind mature specimen - retained

It is proposed to maintain the hedge as present with additional specimen trees planted on the inside (car park side) and immediately adjacent to the hedge. These trees will eventually grow to be effectively hedgehog trees.

Editing mature hedge on north/south divide. Hedge forms eastern boundary of site in this location. Hedge comprises mainly blackthorn and hawthorn. Hedge is currently maintained at a height of 2metres which affords complete screening of the site from the neighbouring property to the east.

It is proposed to maintain the hedge as present.

Editing mature hedge on north/south divide. Hedge forms eastern boundary of site in this location. Hedge comprises mainly blackthorn and hawthorn. Hedge is currently maintained at a height of 2metres which affords complete screening of the site from the neighbouring property to the east.

It is proposed to maintain the hedge as present.

Editing mature hedge on north/south divide. Hedge forms eastern boundary of site in this location. Hedge comprises mainly blackthorn and hawthorn. Hedge is currently maintained at a height of 2metres which affords complete screening of the site from the neighbouring property to the east.

It is proposed to maintain the hedge as present.

Editing mature hedge on north/south divide. Hedge forms eastern boundary of site in this location. Hedge comprises mainly blackthorn and hawthorn. Hedge is currently maintained at a height of 2metres which affords complete screening of the site from the neighbouring property to the east.

It is proposed to maintain the hedge as present.

Editing mature hedge on north/south divide. Hedge forms eastern boundary of site in this location. Hedge comprises mainly blackthorn and hawthorn. Hedge is currently maintained at a height of 2metres which affords complete screening of the site from the neighbouring property to the east.

It is proposed to maintain the hedge as present.

Editing mature hedge on north/south divide. Hedge forms eastern boundary of site in this location. Hedge comprises mainly blackthorn and hawthorn. Hedge is currently maintained at a height of 2metres which affords complete screening of the site from the neighbouring property to the east.

It is proposed to maintain the hedge as present.

Editing mature hedge on north/south divide. Hedge forms eastern boundary of site in this location. Hedge comprises mainly blackthorn and hawthorn. Hedge is currently maintained at a height of 2metres which affords complete screening of the site from the neighbouring property to the east.

It is proposed to maintain the hedge as present.

Editing wind mature specimen - retained

It is proposed to plant a further hedgehog consisting blackthorn, hawthorn, ivy, hawthorn, ivy. The hedges will need to be maintained as a 2 metre tall hedge and will form a reproduction of the existing hedgehog.

Planting schedule - Hawthorn and blackthorn supplied as 30-45cm bare rooted plants. Holly and hawthorn supplied as 30cm pots. All plants to double staggered row - 400mm centres within rows, rows 800mm apart - square. The plants per linear metre. Plants will be protected by rigid cloche or tree guards. Hedges to be maintained until established by hand weeding/ herbicide treatment, watering as necessary and application of slow release fertilizer each year.

Any plants that fail will be replaced during the following planting season.

Site constraints: 20m (approx) (30m x 45m) 20m (approx) (30m x 45m) 3 No Lonicera periclymenum

Editing wind mature specimen - retained

It is proposed to maintain the hedge as present with additional specimen trees planted on the inside (car park side) and immediately adjacent to the hedge. These trees will eventually grow to be effectively hedgehog trees.

Editing wind mature specimen - retained

It is proposed to maintain the hedge as present with additional specimen trees planted on the inside (car park side) and immediately adjacent to the hedge. These trees will eventually grow to be effectively hedgehog trees.

Editing wind mature specimen - retained

It is proposed to maintain the hedge as present with additional specimen trees planted on the inside (car park side) and immediately adjacent to the hedge. These trees will eventually grow to be effectively hedgehog trees.

Editing wind mature specimen - retained

It is proposed to maintain the hedge as present with additional specimen trees planted on the inside (car park side) and immediately adjacent to the hedge. These trees will eventually grow to be effectively hedgehog trees.

Editing wind mature specimen - retained

It is proposed to maintain the hedge as present with additional specimen trees planted on the inside (car park side) and immediately adjacent to the hedge. These trees will eventually grow to be effectively hedgehog trees.

Editing wind mature specimen - retained

It is proposed to maintain the hedge as present with additional specimen trees planted on the inside (car park side) and immediately adjacent to the hedge. These trees will eventually grow to be effectively hedgehog trees.

Editing wind mature specimen - retained

It is proposed to maintain the hedge as present with additional specimen trees planted on the inside (car park side) and immediately adjacent to the hedge. These trees will eventually grow to be effectively hedgehog trees.

Editing wind mature specimen - retained

It is proposed to maintain the hedge as present with additional specimen trees planted on the inside (car park side) and immediately adjacent to the hedge. These trees will eventually grow to be effectively hedgehog trees.

Editing wind mature specimen - retained

It is proposed to maintain the hedge as present with additional specimen trees planted on the inside (car park side) and immediately adjacent to the hedge. These trees will eventually grow to be effectively hedgehog trees.

- Key
- Proposed individual tree planting
 - Supplied as 100-1800mm bare rooted tree in pot
 - Planted in 600x600x400mm pit with slow release fertilizer incorporated
 - Tree supported by stout timber stake and rubber lin/cloche and protected by rigid guard.
 - Trees maintained to maturity - 1 year (2.4m) time cycle around base of tree for herbicide application, water (2 litres) as necessary, application of slow release fertilizer each year, (2) - 100mm and removal of stake and tin as necessary.
 - (A) Silver birch (Betula pendula)
 - (B) Mistletoe ash (Fraxinus excelsior)
 - (C) Cherry (Prunus avium)

ARWEL J GRIFFITH
 LANDSCAPE CONSULTANT
 YMGYNGHORWR TIRLUN
 Plas Mardoch, Rhoscefnant,
 Ysgy Ffôn, LL75 8YU
 01248 150474
 arwel@arwelgriffith.com

TYN Y COED
 MGH A NLYN

Drawing Title
 LANDSCAPING PROPOSALS

Scale 1:1000

Date 2018

Sheet 1 of 1

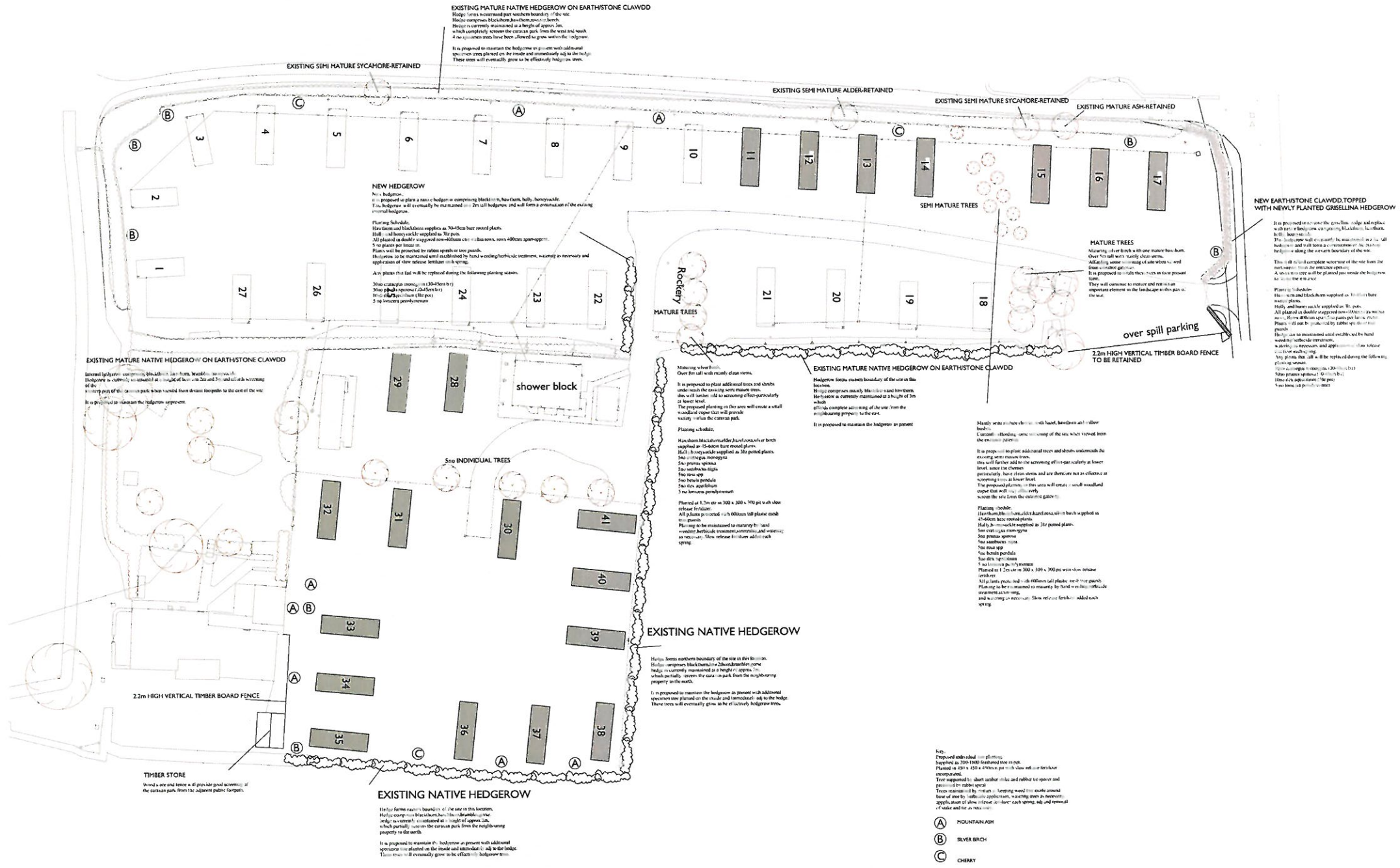

EXISTING MATURE NATIVE HEDGEROW ON EARTHSTONE CLAWDOW
 Hedge forms western part southern boundary of the site.
 Hedge comprises Blackthorn, Hawthorn, Dog Rose, and Bramble.
 Hedge is currently maintained to a height of approx 2m, which completely screens the car park from the road and road.
 4 new specimen trees have been allowed to grow within the hedgerow.
 It is proposed to maintain the hedgerow as present with additional specimen trees planted on the inside and immediately adjacent to the hedge.
 These trees will eventually grow to be effectively hedge line trees.

NEW HEDGEROW
 New hedgerow.
 It is proposed to plant a new hedgerow comprising Blackthorn, Hawthorn, Holly, Honeysuckle.
 This hedgerow will eventually be maintained to 2m tall hedgerow and will form a continuation of the existing hedgerow.
Planting Schedule:
 Hawthorn and Blackthorn supplied as 70-80cm bare rooted plants.
 Holly and Honeysuckle supplied as 100 pots.
 All plants to double staggered row (100cm x 100cm) spacing.
 5 no plants per linear m.
 Plants will be protected by rubber mulch or tree guards.
 This area to be maintained until established by hand watering/irrigation treatment, watering as necessary and application of slow release fertilizer in spring.
 Any plants that fail will be replaced during the following planting season.
Site specific notes:
 5 no Blackthorn (150-180cm B.R.)
 5 no Holly (150-180cm B.R.)
 5 no Honeysuckle (100 pots)
 5 no Hawthorn (100 pots)
 5 no Honeysuckle perennials

EXISTING MATURE NATIVE HEDGEROW ON EARTHSTONE CLAWDOW
 Hedgerow forms western part southern boundary of the site.
 Hedgerow is currently maintained to a height of approx 2m and will completely screen the car park from the road and road.
 It is proposed to maintain the hedgerow as present.

EXISTING MATURE NATIVE HEDGEROW ON EARTHSTONE CLAWDOW
 Hedgerow forms eastern boundary of the site in this location.
 Hedge comprises mainly Blackthorn and Hawthorn.
 Hedgerow is currently maintained to a height of 3m which allows complete screening of the site from the neighbouring property to the east.
 It is proposed to maintain the hedgerow as present.

5m INDIVIDUAL TREES
 Has chosen Maculata, Redwood, Birch, Silver Birch, and Holly.
 All plants to be supplied as 150-180cm bare rooted plants.
 5 no plants per linear m.
 5 no Maculata (100 pots)
 5 no Redwood (100 pots)
 5 no Birch (100 pots)
 5 no Silver Birch (100 pots)
 5 no Holly (100 pots)
 5 no Honeysuckle perennials.
 Planted at 1.2m x 300 x 300 pc with slow release fertilizer.
 All plants to be protected with 600mm tall plastic mesh tree guards.
 Planning to be maintained to maturity by hand watering/irrigation treatment, watering as necessary and application of slow release fertilizer in spring.

EXISTING NATIVE HEDGEROW
 Hedge forms northern boundary of the site in this location.
 Hedge comprises Blackthorn, Hawthorn, Dog Rose, Bramble, and Holly.
 Hedge is currently maintained to a height of approx 2m, which partially screens the car park from the neighbouring property to the north.
 It is proposed to maintain the hedgerow as present with additional specimen trees planted on the inside and immediately adjacent to the hedge.
 These trees will eventually grow to be effectively hedge line trees.

EXISTING NATIVE HEDGEROW
 Hedge forms eastern boundary of the site in this location.
 Hedge comprises Blackthorn, Hawthorn, Dog Rose, Bramble, and Holly.
 Hedge is currently maintained to a height of approx 2m, which partially screens the car park from the neighbouring property to the north.
 It is proposed to maintain the hedgerow as present with additional specimen trees planted on the inside and immediately adjacent to the hedge.
 These trees will eventually grow to be effectively hedge line trees.

NEW EARTHSTONE CLAWDOW TOPPED WITH NEWLY PLANTED GISELLINA HEDGEROW
 It is proposed to remove the existing hedge and replace with a new hedge topped with Giselina.
 The hedge will be planted in a staggered row (100cm x 100cm) spacing.
 A new specimen tree will be planted just inside the hedge line to the east of the site.
Planting Schedule:
 Hawthorn and Blackthorn supplied as 70-80cm bare rooted plants.
 Holly and Honeysuckle supplied as 100 pots.
 All plants to double staggered row (100cm x 100cm) spacing.
 5 no plants per linear m.
 Plants will be protected by rubber mulch or tree guards.
 This area to be maintained until established by hand watering/irrigation treatment, watering as necessary and application of slow release fertilizer in spring.
 Any plants that fail will be replaced during the following planting season.
Site specific notes:
 5 no Blackthorn (150-180cm B.R.)
 5 no Holly (150-180cm B.R.)
 5 no Honeysuckle perennials

MATURE TREES
 Mature trees to be retained on site.
 Over 7m tall with well developed canopies.
 All trees to be protected by rubber mulch or tree guards.
 It is proposed to retain these trees as they provide an important element in the landscape in this part of the site.

EXISTING MATURE NATIVE HEDGEROW ON EARTHSTONE CLAWDOW
 Hedgerow forms eastern boundary of the site in this location.
 Hedge comprises mainly Blackthorn and Hawthorn.
 Hedgerow is currently maintained to a height of 3m which allows complete screening of the site from the neighbouring property to the east.
 It is proposed to maintain the hedgerow as present.
Planting Schedule:
 Hawthorn and Blackthorn supplied as 70-80cm bare rooted plants.
 Holly and Honeysuckle supplied as 100 pots.
 All plants to double staggered row (100cm x 100cm) spacing.
 5 no plants per linear m.
 Plants will be protected by rubber mulch or tree guards.
 This area to be maintained until established by hand watering/irrigation treatment, watering as necessary and application of slow release fertilizer in spring.
 Any plants that fail will be replaced during the following planting season.
Site specific notes:
 5 no Blackthorn (150-180cm B.R.)
 5 no Holly (150-180cm B.R.)
 5 no Honeysuckle perennials

- Key:
 Proposed individual tree planting
 Existing individual tree planting
 Planted as 150 x 150 x 40cm pc with slow release fertilizer incorporated.
 Tree supported by short timber stakes and rubber to prevent and prevent to be robust equal.
 Trees retained in by main planting will be planted around base of site by individual application, watering trees in winter, application of slow release fertilizer each spring, and removal of water and for as necessary.
- (A) MOUNTAIN ASH
 - (B) SILVER BIRCH
 - (C) CHERRY

Plotted on approved site plan. All dimensions are in meters unless otherwise stated.
 Do not scale from this drawing.
 If in doubt - ask.
 This drawing is the copyright of Russell-Hughes and must not be copied or reproduced without permission.

Client: TYN Y COED MORFA NEFYN
 Drawn: MORFA NEFYN
 Proposed SITE PLAN
 Date: MAR 2014

Client: russell-hughes cyf
 56 Bridge Street, Llangefni, Ynys Mon, LL77 7HH
 Tel: 01248 722333
 Fax: 01248 750600
 E-mail: info@russellhughes.co.uk